

MARBO SPORT

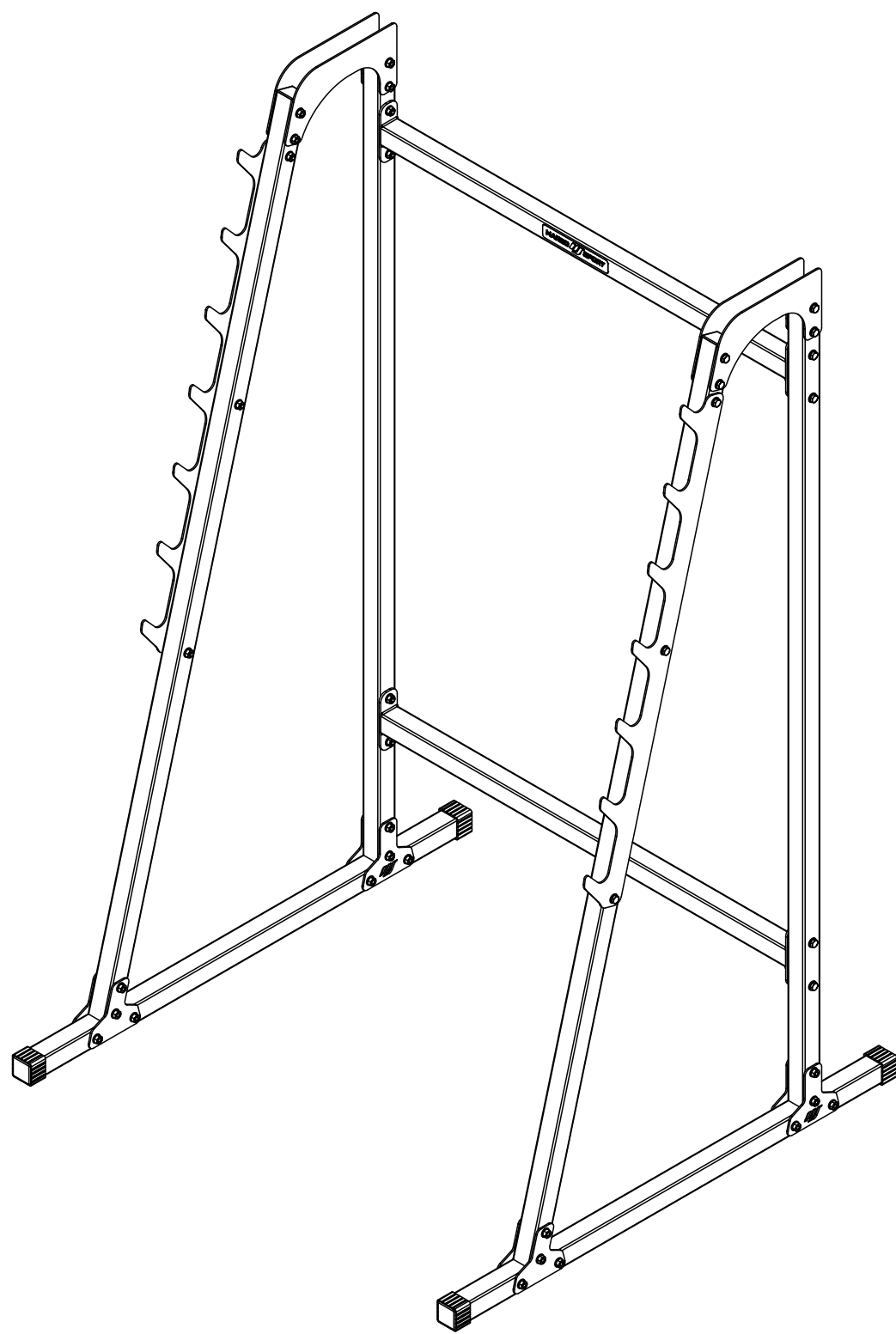

**MAX
200 KG**

DE HANTELABLAGE

EN MULTI RACK

CZ VÍCEÚČELOVÝ STOJAN

RU СТОЙКА УНИВЕРСАЛЬНАЯ

PL STOJAKI WIELOPOZIOMOWE

FR RACK À SQUAT

MH-S204

Nr. części (Part no.)	Ilość (Quantity)	Nazwa części	Opis (Details)	Part name
1	2	Poprzeczka stojaka	MH-S204	The crossbar of the stand
2	4	Blacha	3x137x269	Plate
3	4	Blacha	3x118x123-2	Plate
4	4	Blacha	3x107x123-1	Plate
5	2	Blacha	3x105x980	Plate
6	4	Guma	40x40	Rubber
7	1	Naklejka	27x158	Sticker
8	38	Nakrętka	M8	Nut
9	76	Podkładka	D8	Washer
10	2	Profil	40x40x1,5x1702	Profile
11	2	Profil	40x40x1,5x1066-1	Profile
12	2	Profil	40x40x1,5x1765	Profile
13	38	Śruba	M8x55	Bolt
14	4	Zaślepka	40x40	End cap

Montageanleitung

Assembly / Montageanleitung / Montážní návod / Schemat montażu / Инструкция по монтажу /
Instruction d'installation

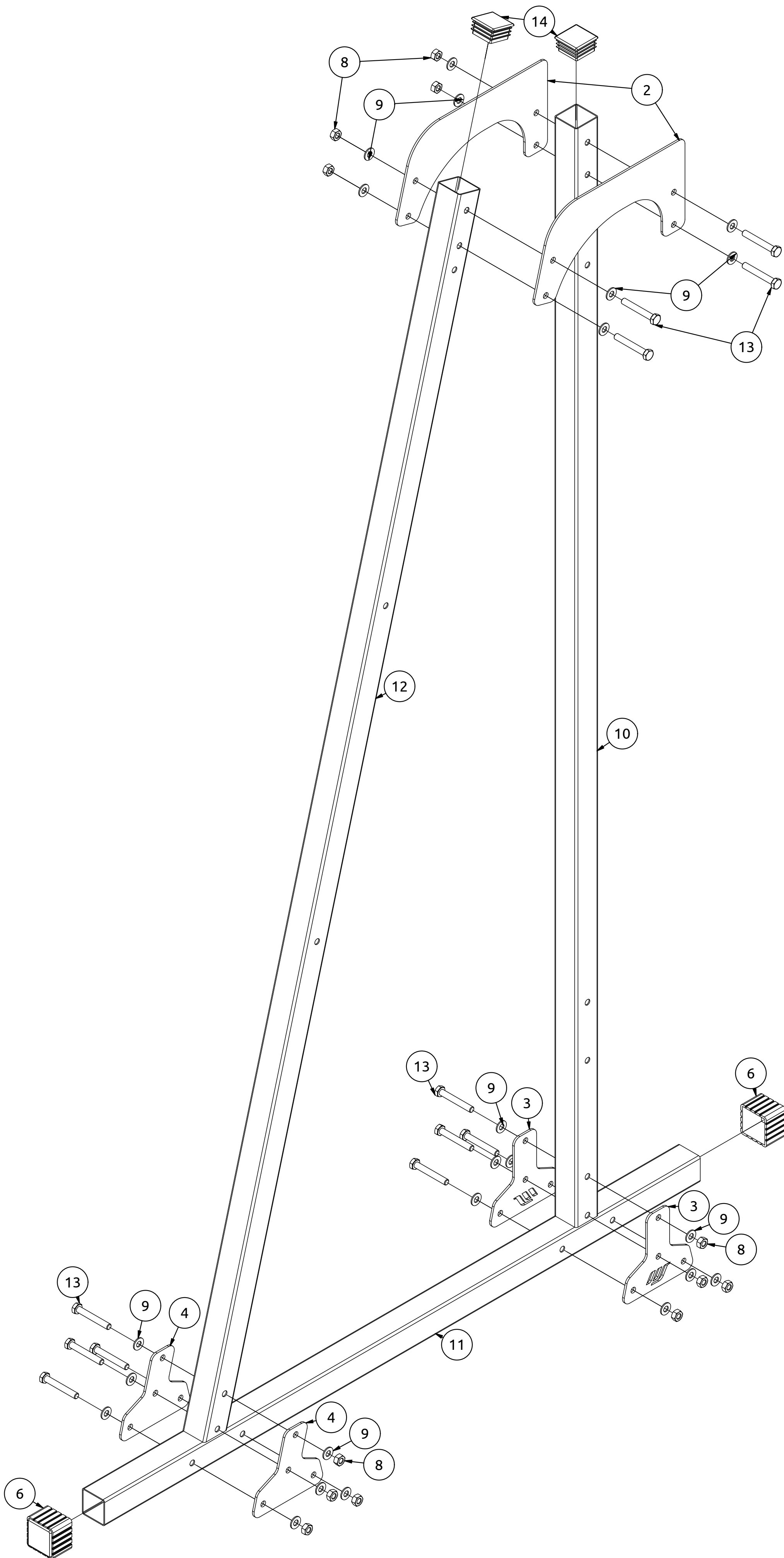

Guma
(Rubber)
40x40
x4

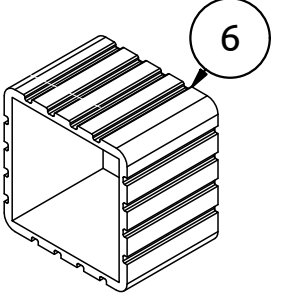

Nakrętka
(Nut)
M8
x12

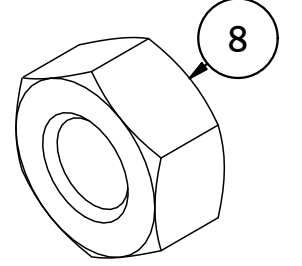

Podkładka
(Washer)
D8
x24

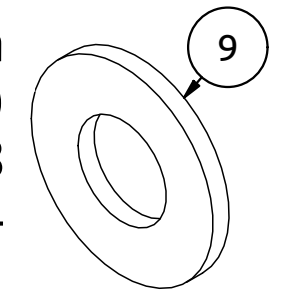

Śruba
(Bolt)
M8x55
x12

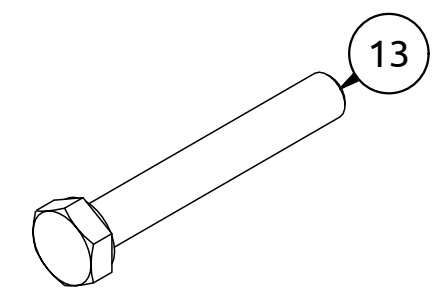

Zaślepka
(End cap)
40x40
x4

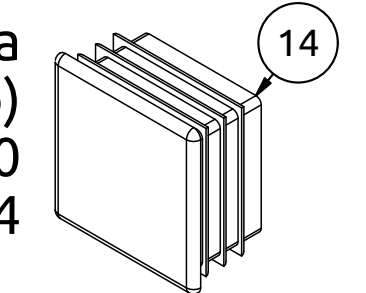

X2

Montageanleitung

Assembly / Montageanleitung / Montážní návod / Schemat montażu / Инструкция по монтажу /
Instruction d'installation

Naklejka
(Sticker)
27x158
x1

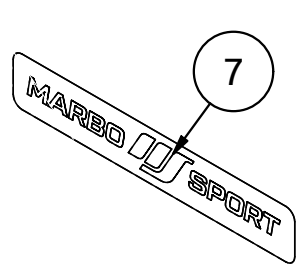

Nakrętka
(Nut)
M8
x4

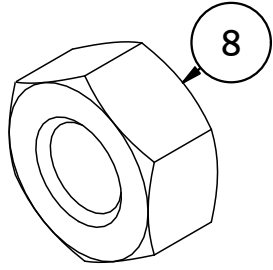

Podkładka
(Washer)
D8
x8

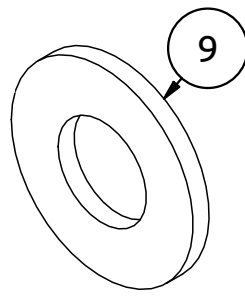

Śruba
(Bolt)
M8x55
x4

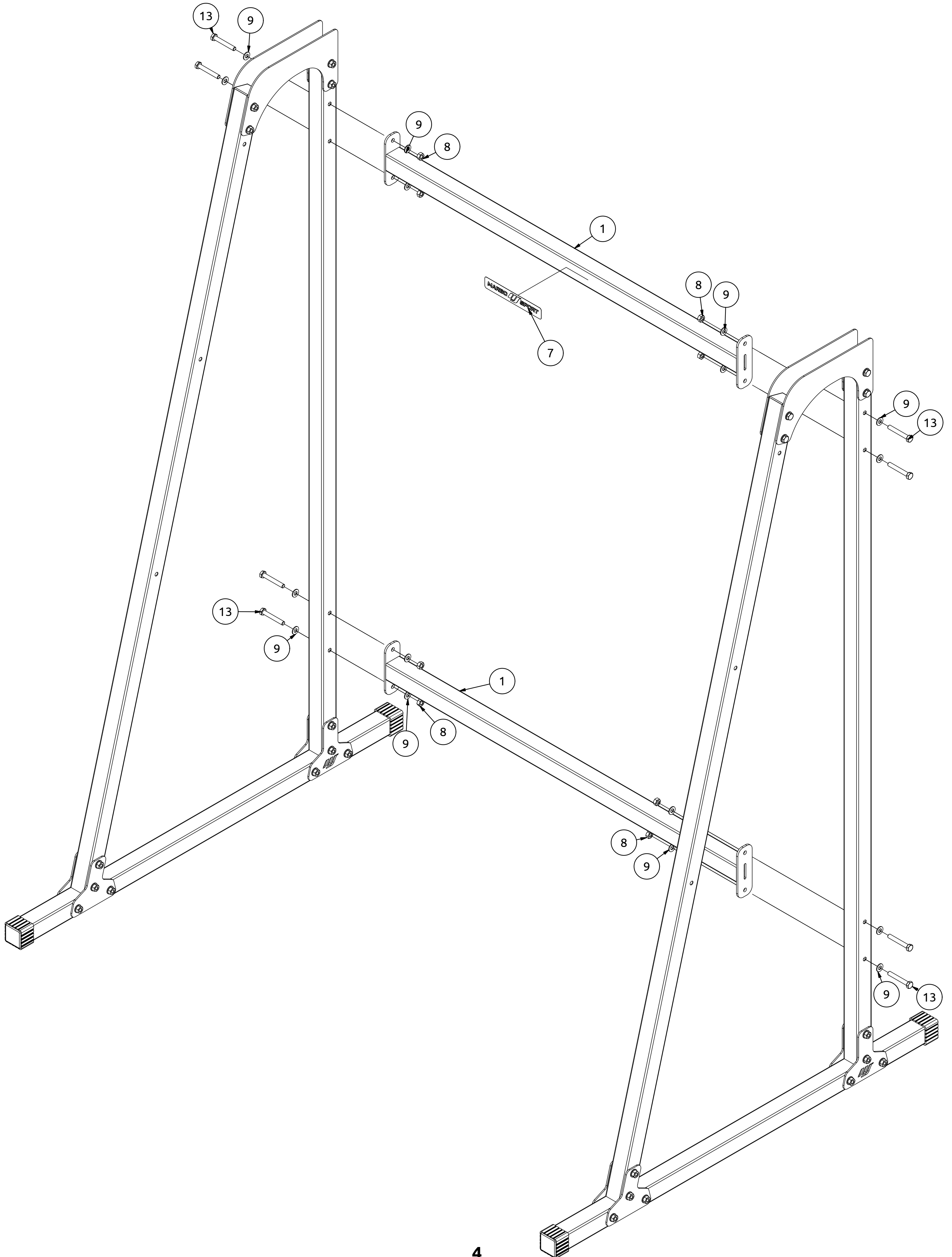
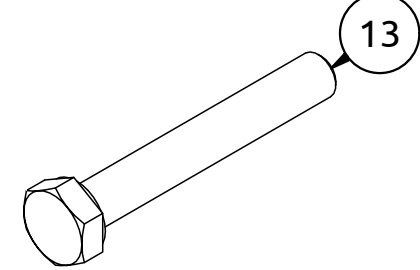

Montageanleitung

Assembly / Montageanleitung / Montážní návod / Schemat montażu / Инструкция по монтажу /
Instruction d'installation

Nakrętka
(Nut)
M8
x6

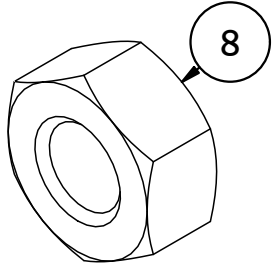

Podkładka
(Washer)
D8
x12

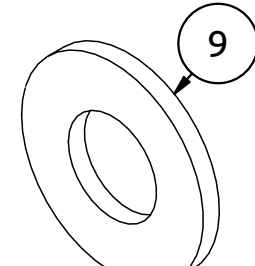

Śruba
(Bolt)
M8x55
x6

